

## Rubber Suspension Unit

## Type DR-C

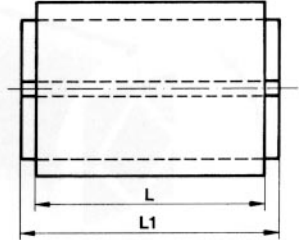

Art. No.	Type	L	L1-0.3	A	D	S	Torque M in Nm at $\alpha$						Weight in kg
							5°	10°	15°	20°	25°	30°	
01 031 010	DR-C 15 x 25	25	30	10:0.2	27:0.2	15	0.7	1.6	2.6	4.0	5.7	8.2	0.06
01 031 011	DR-C 15 x 40	40	45	10:0.2	27:0.2	15	1.1	2.5	4.2	6.4	9.2	13.2	0.10
01 031 012	DR-C 15 x 60	60	65	10:0.2	27:0.2	15	1.6	3.8	6.3	9.6	13.8	19.8	0.15
01 031 001	DR-C 18 x 30	30	35	13-0.2	32:0.2	18	1.9	4.5	7.5	11.0	15.0	20.6	0.10
01 031 002	DR-C 18 x 50	50	55	13-0.2	32:0.2	18	3.2	7.5	12.5	18.3	25.0	34.4	0.16
01 031 003	DR-C 18 x 80	80	85	13-0.2	32:0.2	18	5.1	12.0	20.0	29.3	40.0	55.0	0.25
01 031 004	DR-C 27 x 40	40	45	16:0.3	45:0.2	27	4.7	10.7	17.5	26.9	39.5	57.0	0.25
01 031 005	DR-C 27 x 60	60	65	16:0.3	45:0.2	27	7.0	16.0	26.3	40.3	59.3	85.5	0.36
01 031 006	DR-C 27 x 100	100	105	16:0.3	45:0.2	27	11.7	26.7	43.8	67.2	98.8	142.5	0.60
01 031 007	DR-C 38 x 60	60	70	20:0.3	60:0.3	38	13.0	30.4	50.6	78.0	113.0	162.0	0.60
01 031 008	DR-C 38 x 80	80	90	20:0.3	60:0.3	38	17.3	40.5	67.5	104.0	151.0	216.0	0.79
01 031 009	DR-C 38 x 120	120	130	20:0.3	60:0.3	38	26.0	60.8	101.2	156.0	226.0	324.0	1.16
01 031 013	DR-C 45 x 80	80	90	24:0.3	72:0.3	45	27.6	62.4	104.0	160.0	222.0	320.0	1.00
01 031 014	DR-C 45 x 100	100	110	24:0.3	72:0.3	45	34.5	78.0	130.0	200.0	278.0	400.0	1.22
01 031 015	DR-C 50 x 120	120	130	30:0.3	78:0.3	50	51.0	133.0	250.0	395.0	570.0	780.0	1.80
01 031 016	DR-C 50 x 200	200	210	30:0.3	78:0.3	50	102.0	260.0	475.0	745.0	1070.0	1450.0	3.00

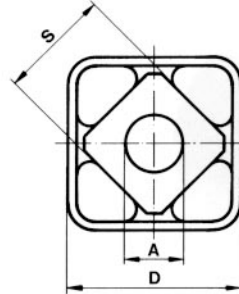
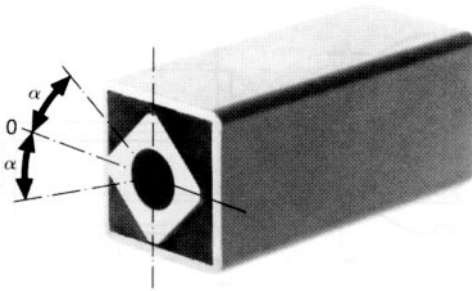
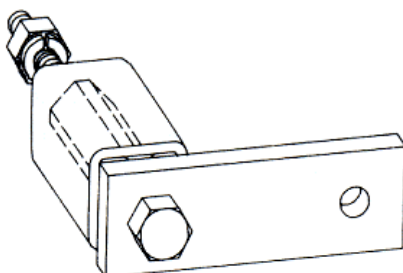

### Bolted Lever Arm on Inner Square

- 레버 팔을 안쪽 사각에 볼트로 체결
- Lever arm을 central 샤프트 스크류로 고정
- 이 때 Leverarm의 운동각은  $>\pm 10^\circ$ 로 한다.
- 최상의 마찰력을 얻기 위하여 코어에 칠해진 페인트를 제거하고 체결한다.